

All levels referenced to Malin Head Datum
KEY PLAN

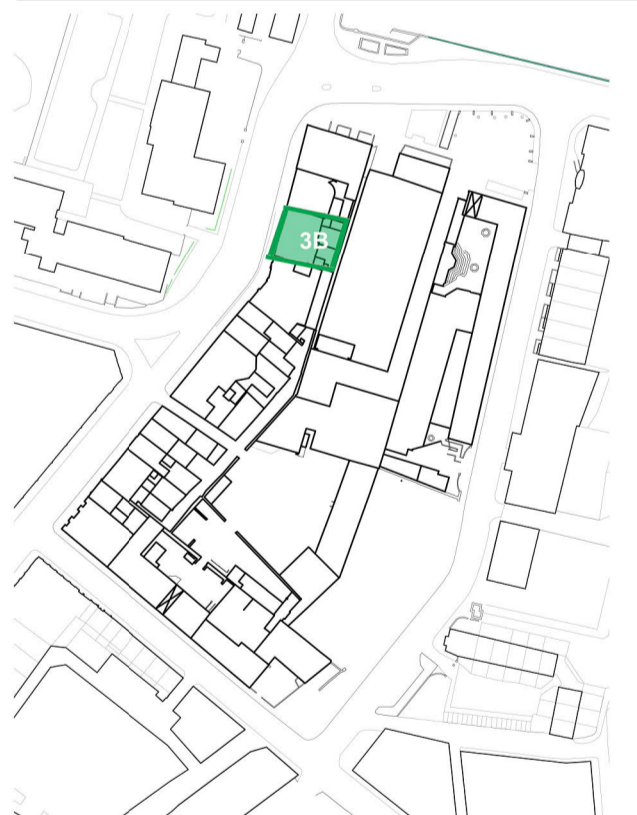

ISSUE/REVISION HISTORY

I/R	DATE	DESCRIPTION
-	Jan 19	Planning Submission

PROJECT NUMBER

60568520

SHEET TITLE

Parcel 3B - Existing Basement & Ground Floor Plans

SCALE 1:100@A1

SHEET NUMBER

OPRA-ACM-Z3B-ZZ-DR-AR-09001

REV

-

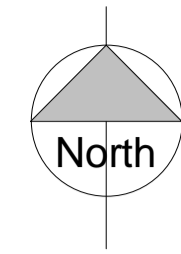

1 Existing Basement Floor Plan

SCALE: 1 : 100



2 Existing Ground Floor Plan

SCALE: 1 : 100

Key:

- ① Sections of plaster cornice retained
- ② Cellars below pavement and street
- ③ Limestone window sills
- ④ Limestone door surround to original entrance with overlight
- ⑤ 19th century shopfront (partially retained)
- ⑥ Original staircase with dado rail retained to wall
- ⑦ Moulded arch and plasters
- ⑧ Cornice
- ⑨ Lugged architrave
- ⑩ Window architraves
- ⑪ Dado rail (behind plasterboard)

Note: Drawings to be read in conjunction with Conservation Categories document, information as supplied by JCA Architects.

This drawing has been prepared for the use of AECOM's client. It may not be used, modified, reproduced or relied upon by third parties, except as agreed by AECOM or as required by law. AECOM accepts no responsibility, and denies any liability, whatsoever, to any party that uses or relies on this drawing without AECOM's express written consent. Do not scale this document. All measurements must be obtained from the stated dimensions.